

KTV2-8

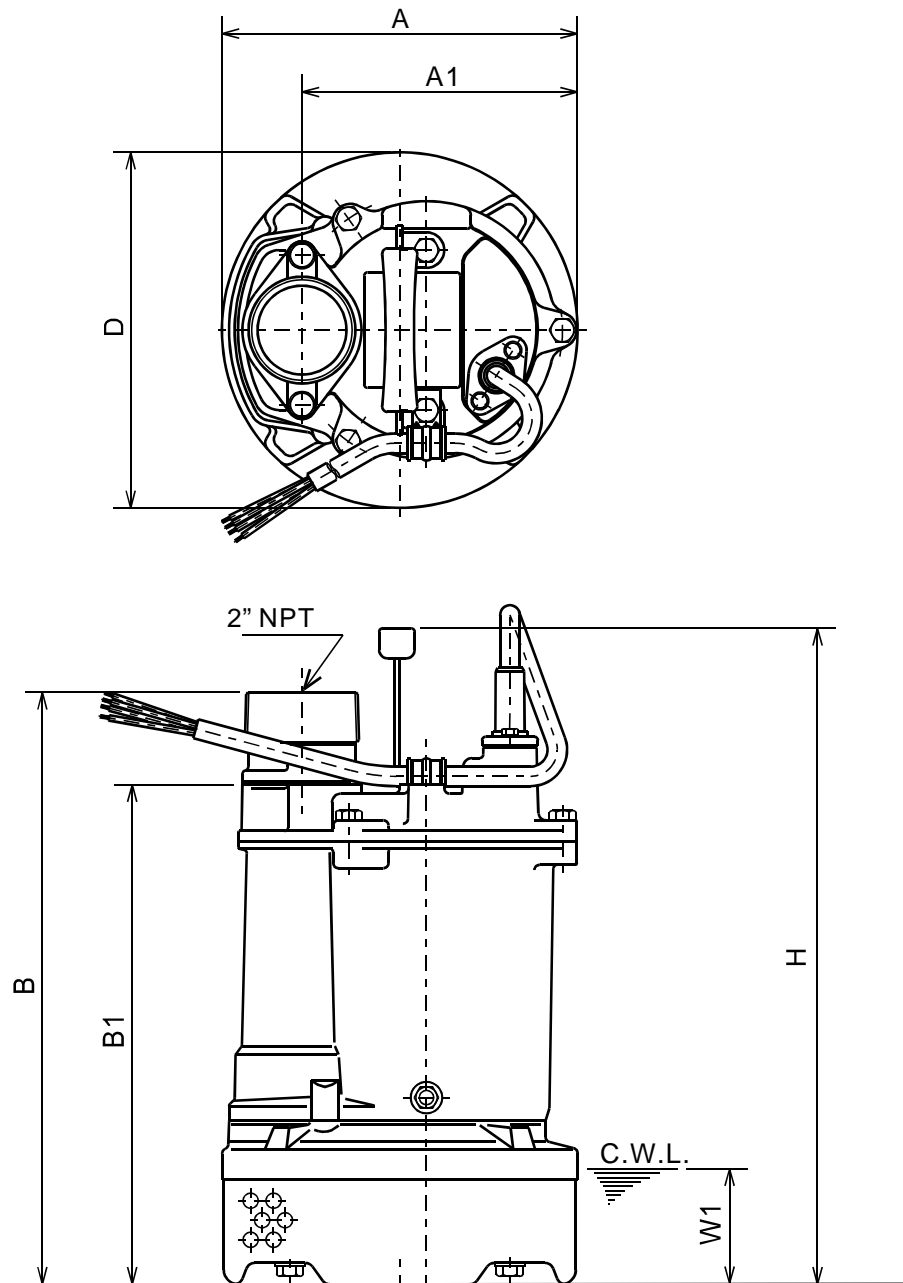

C.W.L. : Continuous running Water Level

DIMENSIONS:USCS (Inch)

Model	HP	NOM. SIZE	Pump & Motor						C.W.L.	Wt. (lbs.)
			A	A1	B	B1	D	H	W1	
KTV2-8	1	2"	7 7/8	6 1/8	13 1/8	11 1/16	7 7/8	14 1/2	2 1/2	25

DIMENSIONS:METRIC (mm)

Model	kW	NOM. SIZE	Pump & Motor						C.W.L.	Wt. (kg)
			A	A1	B	B1	D	H	W1	
KTV2-8	0.75	50	200	155	333	281	200	369	65	11.5



KTV - SERIES SEMI-VORTEX - DEWATERING PUMPS

PERFORMANCE CURVE

MODEL	BORE	HP	KW	RPM	SOLIDS DIA	LIQUID	SG.	VISCOSITY	TEMP.
KTV2-8	2"/50mm	1	0.75	3320	0.334"/8.5mm	Water	1.0	1.123 cSt.	60°F
PUMP TYPE		PHASE	VOLTAGE	AMPERAGE		HZ	STARTING METHOD		INS. CLASS
Semi-Vortex - Dewatering Pump		3	208-230 / 460 / 575	3.4-3.2 / 1.6 / 1.3		60	Direct On Line		E
CURVE No.	DATE	PHASE	VOLTAGE	AMPERAGE		HZ	STARTING METHOD		INS. CLASS
-	-	-	-	-		-	-		-

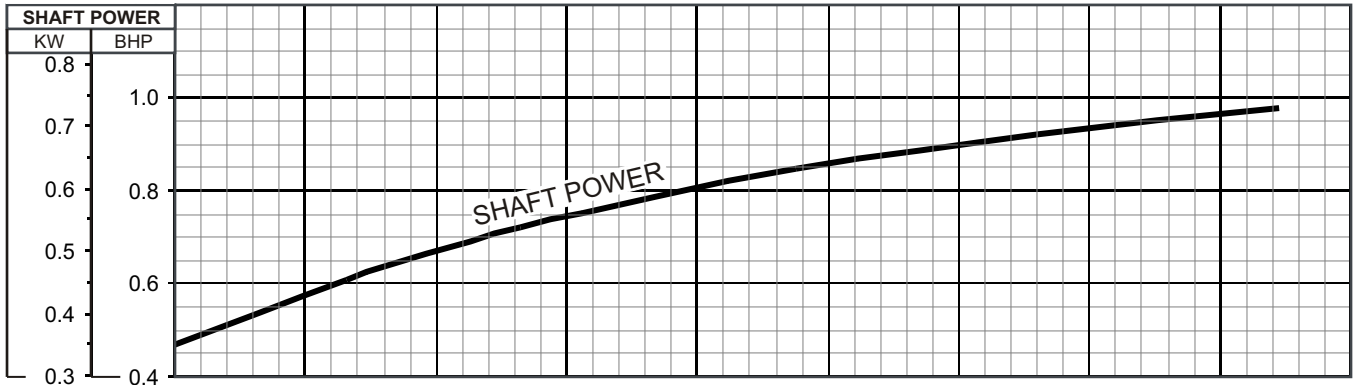
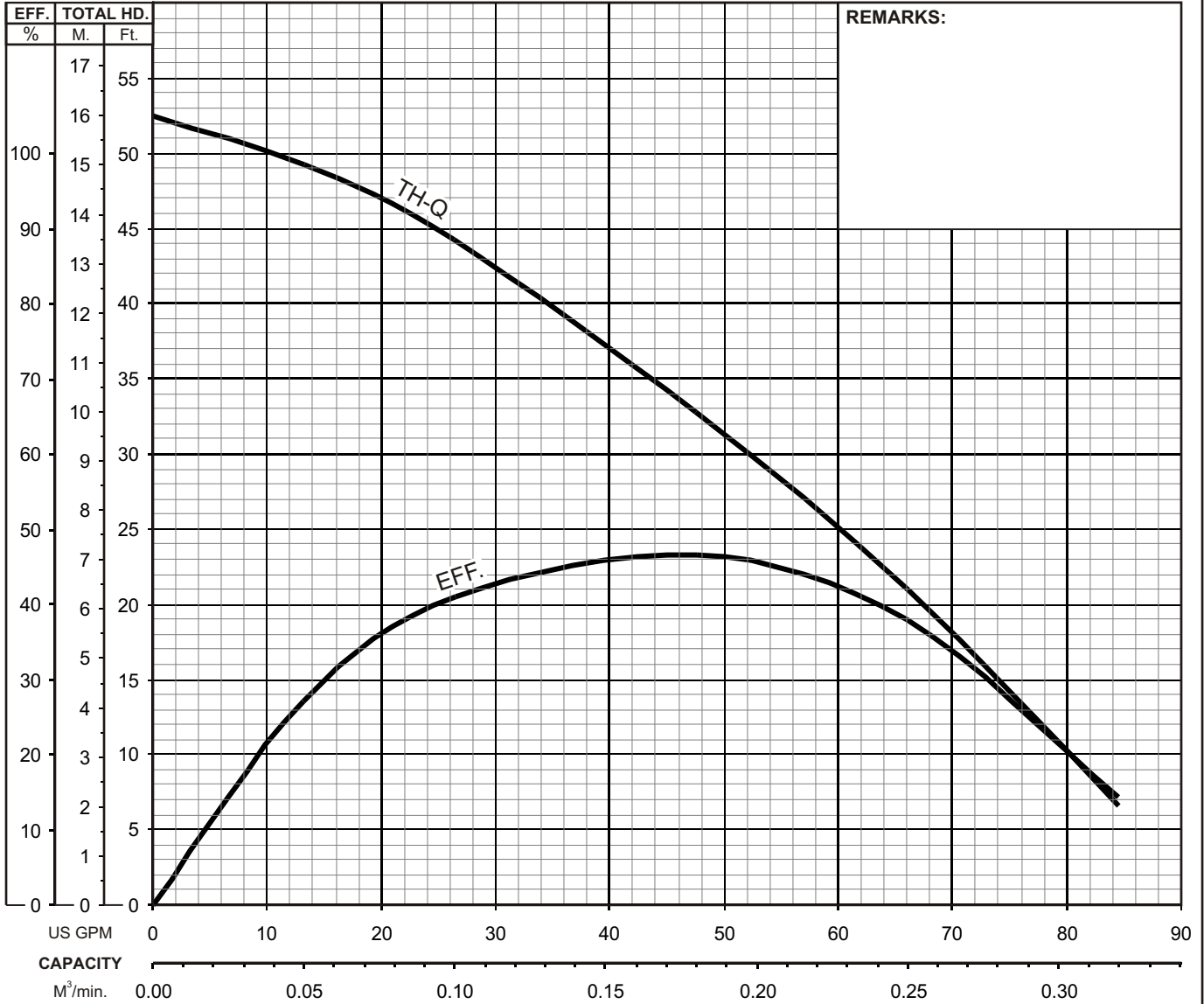

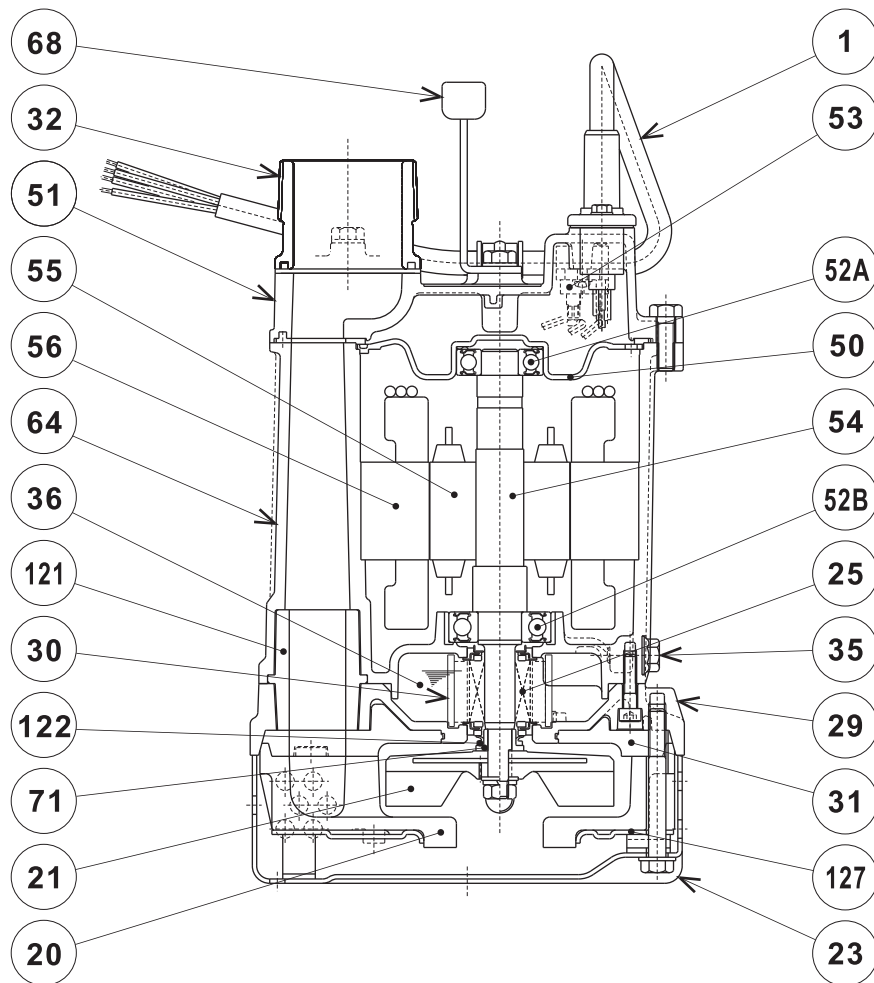
TSURUMI PUMP
**KTV - SERIES
SEMI-VORTEX - DEWATERING PUMPS**
SECTIONAL VIEW

ITEM#	DESCRIPTION	MAIN MATERIAL / NOTE	ASTM, AISI CODE	RELATED EN CODE	Q'TY
1	Power Cable	PVC Sheath AWG16/4-50ft			1
20	Pump Casing	Butadiene Rubber + Natural Rubber			1
21	Impeller	Urethane Rubber			1
23	Suction Strainer	Steel (Cold Rolled)	A109/A1008	EN 10130	1
25	Mechanical Seal	Silicon Carbide / W-14VL			1
29	Oil Casing	Aluminum Alloy Die Casting	B85 A383.0	EN1706 AC-46100	1
30	Oil Lifter	PA Resin			1
31	Wear Ring	Butadiene Rubber + Natural Rubber			1
32	Discharge Connection	Cast Iron / NPT 2"	A48 Class 35	EN1561 GJL-250	1
35	Oil Plug	Stainless Steel	S 30400	1.4301	1
36	Lubricant	Turbine Oil ISO VG32 or SAE10W-20			
50	Motor Bracket	Steel (Hot Rolled)	A1011	EN 10111	1
51	Motor Head Cover	Aluminum Alloy Die Casting	B85 383.0	EN1706 AC-46100	1
52A	Upper Bearing	#6203ZZC3			1
52B	Lower Bearing	#6204ZZC3			1
53	Motor Protector				1
54	Shaft	Stainless Steel	S 42000	1.4028	1
55	Rotor				1
56	Stator				1
64	Motor Housing	Aluminum Alloy Die Casting	B85 A383.0	EN1706 AC-46100	1
68	Handle	Steel (Cold Rolled) + Nitrile Butadiene Rubber	A109/A1008	EN 10130	1
71	Shaft Sleeve	Stainless Steel	S 30400	1.4301	1
121	Duct Sleeve	Styrene Butadiene Rubber			1
122	V-Ring	Nitrile Butadiene Rubber			1
127	Fixing Plate	Carbon Steel	A109/A1008	EN 10130	1

PARTS LIST		LIGHTWEIGHT DEWATERING PUMP			2/6/2018	
ITEM	PART No.	DESCRIPTION	QTY	SIZE	MATERIAL	NOTES
1	001-803-33	Cabtyre Cable Set (50') 60Hz (USA)	1	VCT4Cx1.25mm2	LBT	
2	140-054-19	Hex.Bolt	2	M8x20	SUS304	
3	010-112-10	Cable Clip	1	LB2-480	SPC	
4	010-126-17	Cable Clip Rubber	1	HS2	NBR	
5	140-427-17	Hex.Bolt (w/Plain Washer)	2	M5x15	SUS304	
6	003-190-10	Gland	1		SUS316	
7	140-055-10	Hex.Bolt	2	M8x25	SUS304	
8	142-114-14	Plain Washer	2	M8 (D=15.5)	SUS304	
9	032-000-67	Hose Coupling	1	50mm(LB)	ADC	
10	121-138-19	Packing	1	LB(P.C.84)	NBR	*
11	068-136-22	Handle	1	LB	SPC+NBR	
12	140-055-10	Hex.Bolt	3	M8x25	SUS304	
13	051-221-10	Motor Head Cover	1		ADC	
14	053-199-14	Motor Protector 220V-60Hz(USA)	1	KA311-DAXL78	(T.C)	
	053-443-16	Motor Protector 440V-60Hz(USA)	1	KA311-DAXL68	(T.C)	
		Motor Protector 575V-60Hz(USA)	1		(T.C)	
15	143-126-12	Pan Screw (w/Spring Washer/Plain Washer)	2	M4x12	SWRM	
16		Earth Terminal	1Set			
17	143-085-34	Pan Screw (w/Spring Washer)	1	M4x6	C3604	
18	121-455-15	Packing	1	KTV2-8	CR	*
19	050-408-10	Motor Bracket	1		SPHC	
20	142-194-18	Wave Washer	1	6203	SK5	
21	052-102-17	Bearing	1	6203ZZC3		
22	055-678-18	Rotor	1Set			
23	056-693-12	Stator 220V-60Hz(USA)	1Set			
	056-730-12	Stator 440V-60Hz(USA)	1Set			
		Stator 575V-60Hz(USA)	1Set			
24	052-103-18	Bearing	1	6204ZZC3		
25	064-473-19	Motor Frame	1		ADC	
26	121-248-13	Packing	1	d8.2xd13.5x2t	PE	*
27	035-126-14	Oil Plug	1	M8x16(B=13)	SUS304	
28	025-291-10	Mechanical Seal	1	W-14VL	SSiC	
29	122-131-15	O-Ring	1	G-100(99.4xd3.1)	NBR	*
30	121-001-05	Packing	1	KTV2-8	SBR	*
31	029-407-13	Oil Casing	1	KTV2-8	ADC	
32	140-253-10	Hex.Socket Cap Bolt	4	M6x25	SUS304	
33	031-141-26	Wear Ring	1	KTV2-8	Rubber	
34	122-441-11	V-Ring	1	VR-14	NBR	
35	071-292-14	Shaft Sleeve	1	LB3-250/480	SUS304	

PARTS LIST		LIGHTWEIGHT DEWATERING PUMP				2/6/2018
ITEM	PART No.	DESCRIPTION	QTY	SIZE	MATERIAL	NOTES
36	021-007-53	Impeller (60Hz)	1	60Hz	Urethane Rubber	
	021-007-52	Impeller (50Hz)	1	50Hz	Urethane Rubber	50Hz OPTION
37	142-127-23	Plain Washer	1	M8	SPC	
38	142-163-18	Spring Washer	1	M8	SUS304	
39	141-030-12	Hex.Cap Nut	1	M8	SUS304	
40	020-881-34	Pump Casing	1	KTV2-8	BR+NR	
41	127-251-17	Fixing Plate	1	KTV2-8	SPCC	
42	023-439-16	Strainer Stand	1	KTV2-8	SPCC	
43	142-127-23	Plain Washer	4	M8	SPC	
44	140-064-12	Hex.Bolt	4	M8x70	SUS304	
AA	030-132-18	Oil Lifter	1	KTV2-8	Resin	
	173-490-13	Packing O-Ring Set	1Set	(Marked by *)		
10	121-138-19	Packing (Hose Coupling)	1	LB(P.C.84)	NBR	*
18	121-455-15	Packing (Head Cover/M.Frame)	1	KTV2-8	CR	*
26	121-248-13	Packing (Oil Plug)	1	d8.2xd13.5x2t	PE	*
29	122-131-15	O-Ring (M.Frame/O.Casing)	1	G-100(99.4xd3.1)	NBR	*
30	121-001-05	Packing (Water Way, Low.)	1	KTV2-8	SBR	*
		Lubricant		Turbine Oil VG32 150ml		

PARTS LIST		LIGHTWEIGHT DEWATERING PUMP			2/6/2018	
ITEM	PART No.	DESCRIPTION	QTY	SIZE	MATERIAL	NOTES

EXPLODED VIEW

KTV2-8

